

ALKO Heavy Duty Axle

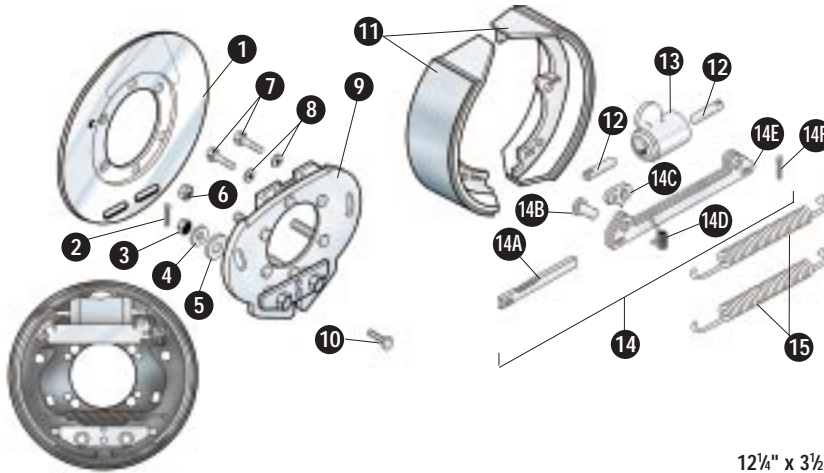

Hydraulic Brake for 10,000 Lb. and 12,000 Lb. Axles



12 1/4" x 3 1/2" Hydraulic Brake Assembly

No.	Hub Part Description	Part No.
0	LH or RH Brake Assembly	568213
1	Dust Cover Assembly	568229
2	Shoe Hold Down Cotter Pin	568224
3	Shoe Hold Down Nut	568233
4	Shoe Hold Down Spring	568225
5	Shoe Hold Down Washer	568232
6	Nut 1/2" - 20 UNF Hex Standard	568235
7	Bolt 3/8" - 16 x 3/4"	568231
8	Lock Washer 3/8"	363334
9	Backing Plate Assembly	—
10	Shoe Hold Down Bolt	568227
11	Shoe & Lining	568234
12	Push Rod	568228
13	Cylinder-Wheel	568214
14	Self-Adjuster Assembly	568259
14A	Rack	—
14B	Clevis Pin 3/8" x 3/4"	—
14C	Pawl	—
14D	Spring-Pawl	—
14E	Sleeve Assembly	—
14F	Cotter Pin 5/32" x 3/4"	—
15	Retract Spring	568226
16	Connector-Brake Line, Not Shown	568230

ALKO KOBER CORPORATION

21611 Protecta Dr.
Elkhart, IN 46516
219-294-6651
219-294-7267 Fax

301 N. Kennedy
Shawnee, OK 74801
405-273-9315
405-273-1054 Fax

315 Road 911
Baldwyn, MS 38824
601-365-5566
601-365-9222 Fax