

# ALKO Heavy Duty Axles

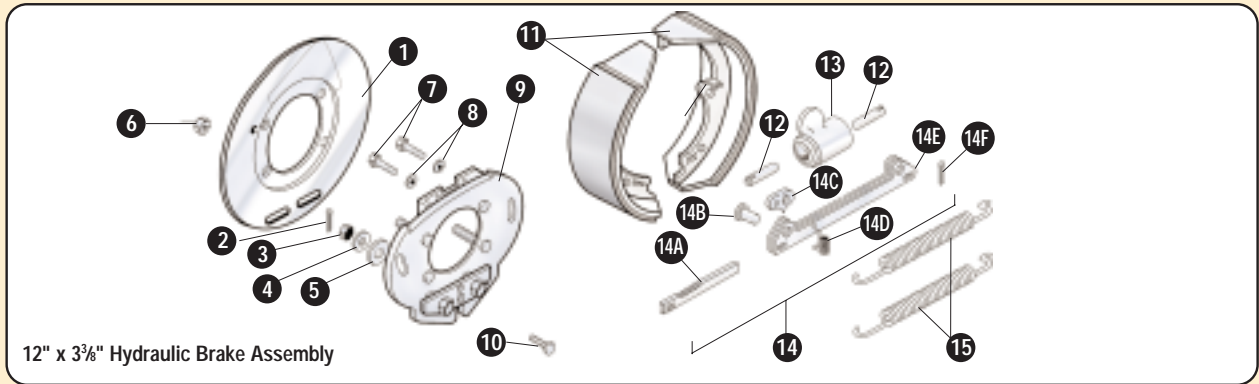

## Hydraulic Brake for 8,000 Lb. Axles



12" x 3 3/8" Hydraulic Brake Assembly

No.	Brake Part Description	Part No.
0	LH or RH Brake Assembly	568004
1	Dust Cover	568289.3
2	Shoe Hold Down Cotter Pin	568224
3	Shoe Hold Down Nut	568233
4	Shoe Hold Down Spring	568225
5	Shoe Hold Down Washer	568232
6	Nut 1/2" - 20 UNF Hex Standard	568235
7	Bolt 3/8" - 16 x 3/4"	568231
8	Lock Washer 3/8"	363334
9	Backing Plate Assembly	—
10	Shoe Hold Down Bolt	568227
11	Shoe & Lining Assembly	363925

No.	Brake Part Description	Part No.
12	Push Rod (Wheel Cylinder)	568228
13	Cylinder-Wheel	568296
14	Self-Adjuster Assembly	568259
14A	Rack	—
14B	Clevis Pin 3/8" x 3/4"	—
14C	Pawl	—
14D	Spring-Pawl	—
14E	Sleeve Assembly	—
14F	Cotter Pin 5/32" x 3/4"	—
15	Retract Spring	568226
16	Connector-Brake Line, Not Shown	568230

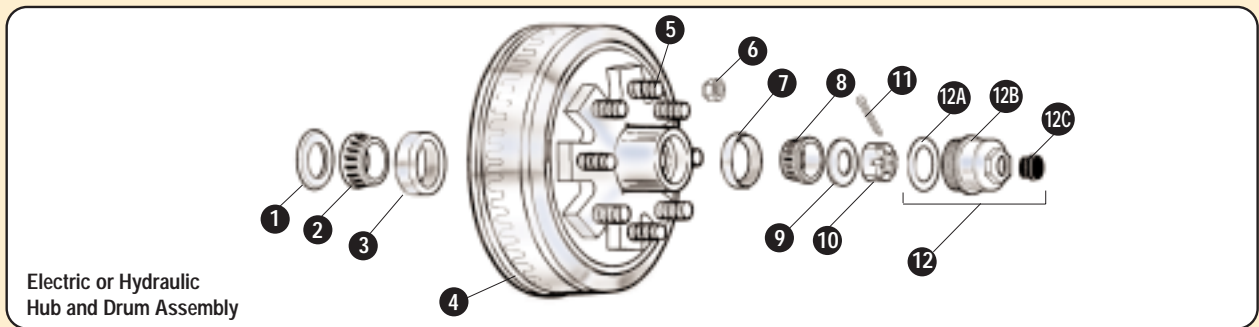

Electric or Hydraulic  
Hub and Drum Assembly

No.	Hub Part Description	Part No.
1	Oil Seal	568273
2	Inner Bearing Cone, 25580	363196
3	Inner Cup, 25520	363911
4	Hub/Drum Assembly	363694
5	Wheel Stud, 9/16"	363906
6A	Wheel Nut, 9/16" 60° Cone	363895
6B	Wheel Nut, 9/16" 90° Cone	363696
7	Outer Cup, 02420	363917

No.	Hub Part Description	Part No.
8	Outer Bearing Cone, 02475	363604
9	Spindle Washer	363259
10	Spindle Nut	363257
11	Cotter Pin	363258
12	Oil Cap Assembly	363587
12A	Gasket, Oil Cap	568298
12B	Oil Cap	568268
12C	Oil Cap Plug	568223